

RL20000 S-Beam, Alloy Steel, NTEP 1:5000 III/1:10,000 IIIIL

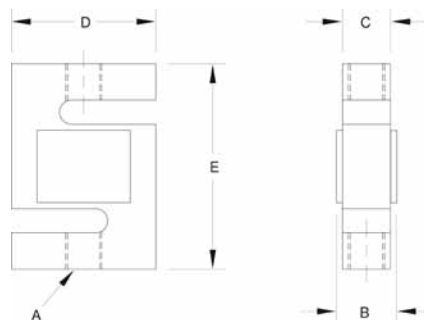

Picture is a representation of actual product



SPECIFICATIONS

Full Scale Output:
3.0mV/V

Output Resistance:
350 ohms, +/- 3

Input Resistance:
385 ohms, +/- 5

Material/Finish:
High-alloy steel, nickel plated

Temperature:
Compensated range
14°F to 104°F/-10°C to 40°C

Seal Type:
Environmentally sealed, IP67

Safe Overload:
150% Full scale

Rated Excitation:
10V DC (15V maximum)

Nonlinearity:
0.03% Full scale

Hysteresis:
0.02% Full scale

Insulation Resistance:
5000 megohms

Cable Length:
20'±6.1 m

Cable Diameter:
.200 polyurethane jacket

Cable Color Code:

- Red + Excitation
- Black - Excitation
- Green + Signal
- White - Signal

Warranty:
Two-year limited warranty

Approvals:



DIMENSIONS

RATED CAPACITY	A	B	C	D	E
lb/inches					
25-300	1/4-28 UNF-2B	.75	.50	2.00	2.50
500-1500	1/2-20 UNF-2B	1.00	.75	2.00	2.50
2000-2500	1/2-20 UNF-2B	1.25	1.00	2.00	2.50
3000	1/2-20 UNF-2B	1.25	1.00	3.00	4.00
5000-10,000	3/4-16 UNF-2B	1.25	1.00	3.00	4.00
15,000	1-12 UNF-2B	1.50	1.25	4.00	5.50
20,000	1 1/4-12 UNF-2B	2.25	2.00	5.00	7.00
kg/mm					
11.3-136.1	1/4-28 UNF-2B	19.1	12.7	50.8	63.5
226.8-680.4	1/2-20 UNF-2B	25.4	19.1	50.8	63.5
907.2-1134.0	1/2-20 UNF-2B	31.8	25.4	50.8	63.5
1360.8	1/2-20 UNF-2B	31.8	25.4	76.2	101.6
2268.0-4535.9	3/4-16 UNF-2B	31.8	25.4	76.2	101.6
6803.9	1-12 UNF-2B	38.1	31.8	101.6	139.7
9071.9	1 1/4-12 UNF-2B	57.2	50.8	127.0	177.8

RL20000 S-Beam, Alloy Steel, NTEP 1:5000 III/1:10,000 IIII

ORDER INFORMATION

LOAD RATING		PART #	PRICE
25 lb	(11.3 kg)	21428	Consult
50 lb	(22.7 kg)	21429	Consult
75 lb	(34.0 kg)	21430	Consult
100 lb	(45.4 kg)	21431	Consult
150 lb	(68.0 kg)	21432	Consult
200 lb	(90.7 kg)	21433	Consult
250 lb	(113.4 kg)	21434	Consult
300 lb	(136.1 kg)	21435	Consult
500 lb	(226.8 kg)	21436	Consult
750 lb	(340.2 kg)	21437	Consult
1000 lb	(453.6 kg)	21438	Consult
1500 lb	(680.4 kg)	21439	Consult
2000 lb	(907.2 kg)	21440	Consult
2500 lb	(1134.0 kg)	21441	Consult
3000 lb	(1360.8 kg)	21442	Consult
5000 lb	(2268.0 kg)	21443	Consult
10,000 lb	(4535.9 kg)	21444	Consult
15,000 lb	(6803.9 kg)	21445	Consult
20,000 lb	(9071.9 kg)	21446	Consult
3/8-24 Nipple		31533*	Consult
3/8-24 to 1/4-18 NPT		31534*	Consult

* Parts #31533 and #31534 must be installed together to form the Conduit Adapter Kit
Conduit Adapter Kit* (must be factory installed to maintain warranty)

INTERCHANGEABLE PRODUCTS

MANUFACTURER	MODEL
**Artech®	20210 (15 K has 1"-14)

** Except 15K

WEIGH MODULE AVAILABLE

MANUFACTURER	MODEL	PAGE #
Rice Lake Weighing Systems	ITCM Isolated Tension Cell Mount	364

SPECIAL LOAD CELLS

LOAD RATING	PART #	PRICE
2000 lb	21356 35 ft	Consult
5000 lb	17044 30 ft	Consult
20,000 lb	17045 30 ft	Consult

These load cells have 30' of cable and trimmed outputs and are used in many batch plants