

# K I L O T E C H

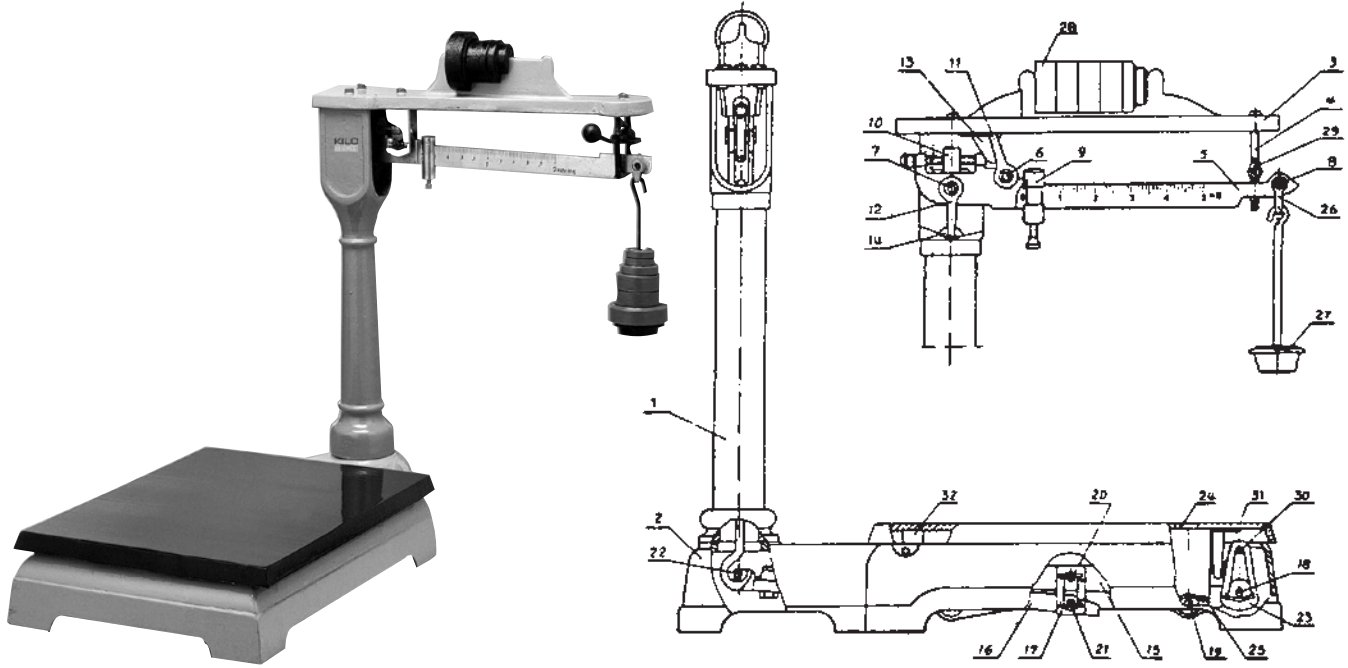

## PARTS LIST - MODELS SP900 & SP901

Ref.#	Name of Part	Qty.	Ref.#	Name of Part	Qty.
1	Metal Pillar	1	17	Center Link Assembly	1
2	Outside Frame	1	18	Lever Fulcrum Pivot	4
3	All Metal Cap	1	19	Lever Load Pivot	4
4	Beam Rack & Switch	1	20	Long Lever Centre Pivot	1
5	Beam	1	21	Short Lever Tip Pivot	1
6	Beam Fulcrum Pivot	1	22	Nose Iron Pivot	1
7	Beam Load Pivot	1	23	Corner Link	4
8	Beam Tip Pivot	1	24	Platform	1
9	Poise	1	25	Steel	4
9A	Poise Knob	1	26	Tip Pivot Loop	1
10	Balance Poise	1	27	Counter Poise	1
11	Fulcrum Pivot Loop	1	28	Counterweights (kg & lb.)	2 sets
12	Load Pivot Loop	1	29	Switch (see #4)	1
13	Pillar Cap	1	30	Corner Pin	4
14	Steelyard Rod w/Hook	1	31	Platform Tail Pin	1
15	Long Lever	1	32	Platform Head Pin	1
16	Short Lever	1			

## DIRECTIONS FOR ASSEMBLY



1) Unpack and carefully remove all parts from the carton.



2) Tighten the metal pillar (#1) to the outside frame (#2) with bolts.



3) Insert steelyard hook (#14) through metal pillar and hook onto nose pivot (#22).



4) Attach steel yard hook (#14) to loop (#12) on beam.

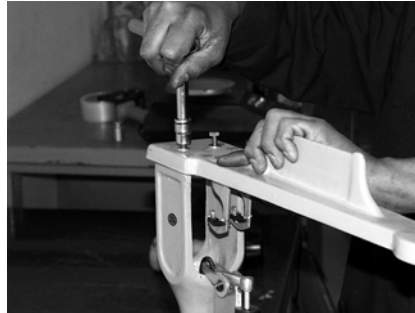

5) Tighten all metal cap (#3) to metal pillar (#1) with bolts.

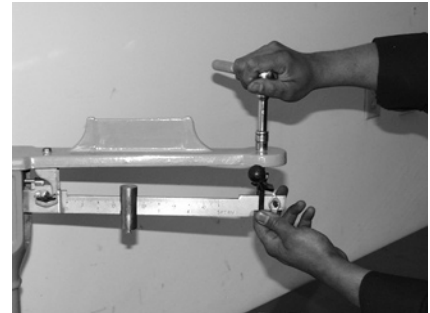

6A) Hook loop of beam (#12) onto all metal cap (#3).  
B) Insert end of beam (#5) to lower section of beam rack and switch (#4)  
C) Securely tighten to all metal cap (#3).

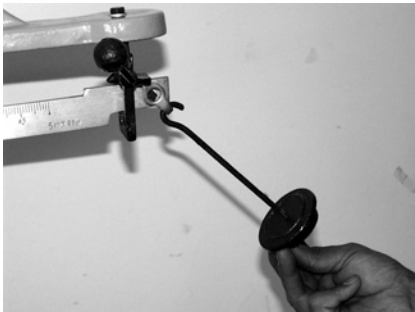

7) Install counterpoise (#27) to tip pivot loop (#26).



8) Slide the platform (#24) with the hook underneath toward metal pillar.



9) With no load on the platform, carefully adjust the "O" position of the scale using the screw at the end of the balance ball (#10).

10) To verify accuracy, place a test weight on scale.

YOUR SCALE IS NOW READY FOR OPERATION